



107 High Street, Colchester, Essex, CO1 1TH





- Gross Internal Area 8,670 sq. ft (805sq.m)
- Residential Development Opportunity
- Planning Permission for 16 Apartments
- Prominent City Centre Premises
- Close to Castle, Castle Park and multi storey parking
- Retail Investment also available
- **FREEHOLD FOR SALE**



## Location

Now with City status, Colchester is a major economic centre in north Essex with a resident population of circa 185,000 people which is due to expand to over 200,000 people.

The City benefits from excellent access to the A12, M25 (J. 28), the A120 to the Ports of Harwich and Stansted Airport and via the A14 via Ipswich to the Midlands. Main line rail links to London Liverpool Street have a fastest journey time of 46 minutes.

The property occupies a prominent location on the eastern edge of the High Street and into the Dutch Quarter, close to the Castle and recreational amenities in Castle Park.

## Description

The property which was formerly used as a club comprises a part three storey/part single storey building of brick construction beneath various pitched and flat roofs with basement level offering pedestrian entrances from Maidenburgh Street and Museum Street.

## Accommodation

The property benefits from the following Gross Internal Areas (GIA):

Ground Floor	2,594 Sq Ft
First Floor	3,747 Sq Ft
Second Floor	2,329 Sq Ft
<b>TOTAL</b>	<b>8,670 Sq Ft (805 Sq M)</b>







## Terms

Freehold offers in the region of £535,000 are invited. Consideration will be given to selling the ground floor retail investment in 107 High Street which is currently let. Details are available upon request.

## Town Planning

The property benefits from planning permission to part demolish the rear extension (roof) and the erection of two additional storeys, and the conversion of the upper floors to create 16. No. apartments (Ref. 231077). The proposed development will have a Gross Floor Area of 10,485sq.ft(974sq.m). Interested parties are advised to contact Colchester City Council on 01206 282222.

## Rateable Value

The property appears in the Valuation List with the following Rateable Values:

107 High Street	£26,500
2 <sup>nd</sup> Floor 107 High Street	£6,600

## VAT

Further details are available upon request.

## Legal Fees

Each party is to bear their own legal costs throughout the course of any transaction.

## EPC

The property has an EPC rating of G192. A copy of the certificate is available upon request.

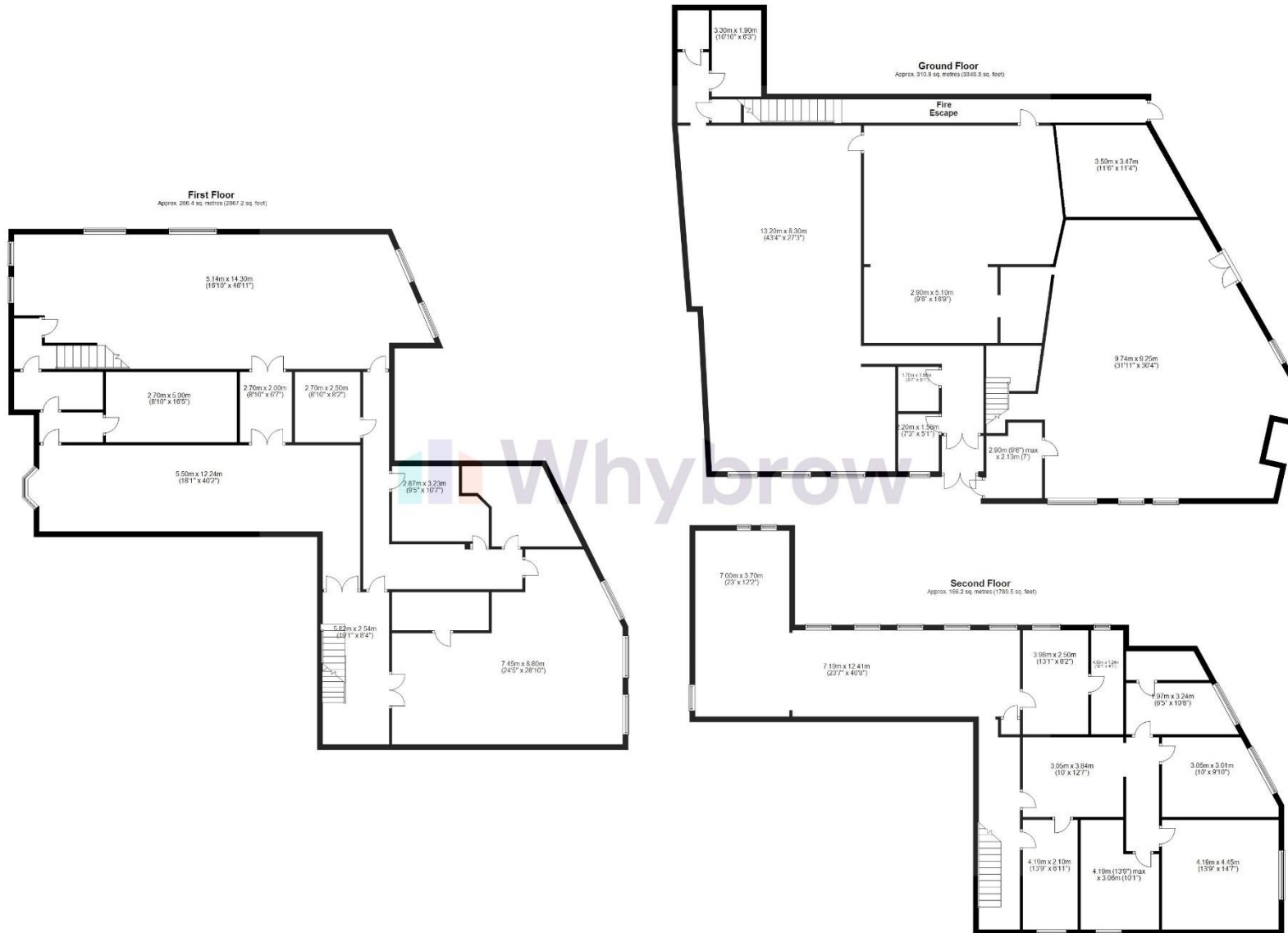

Total area: approx. 743.4 sq. metres (8002.0 sq. feet)

All measurements have been taken as a guide to prospective buyers only and are not precise. This plan is for illustrative purposes only and no responsibility for any error, omission or misstatement. The services, systems and appliances shown have not been tested and no guarantee as to their operability or efficiency can be given. Measurements may have been taken from the widest area and may include wardrobe/closet space. To be accurate in your own measurements, please refer to the actual floor plan. Whybrow is not responsible for any measurements included on this plan. Buyers are advised to take their own measurements. Whybrow is not responsible for any measurements included on this plan.







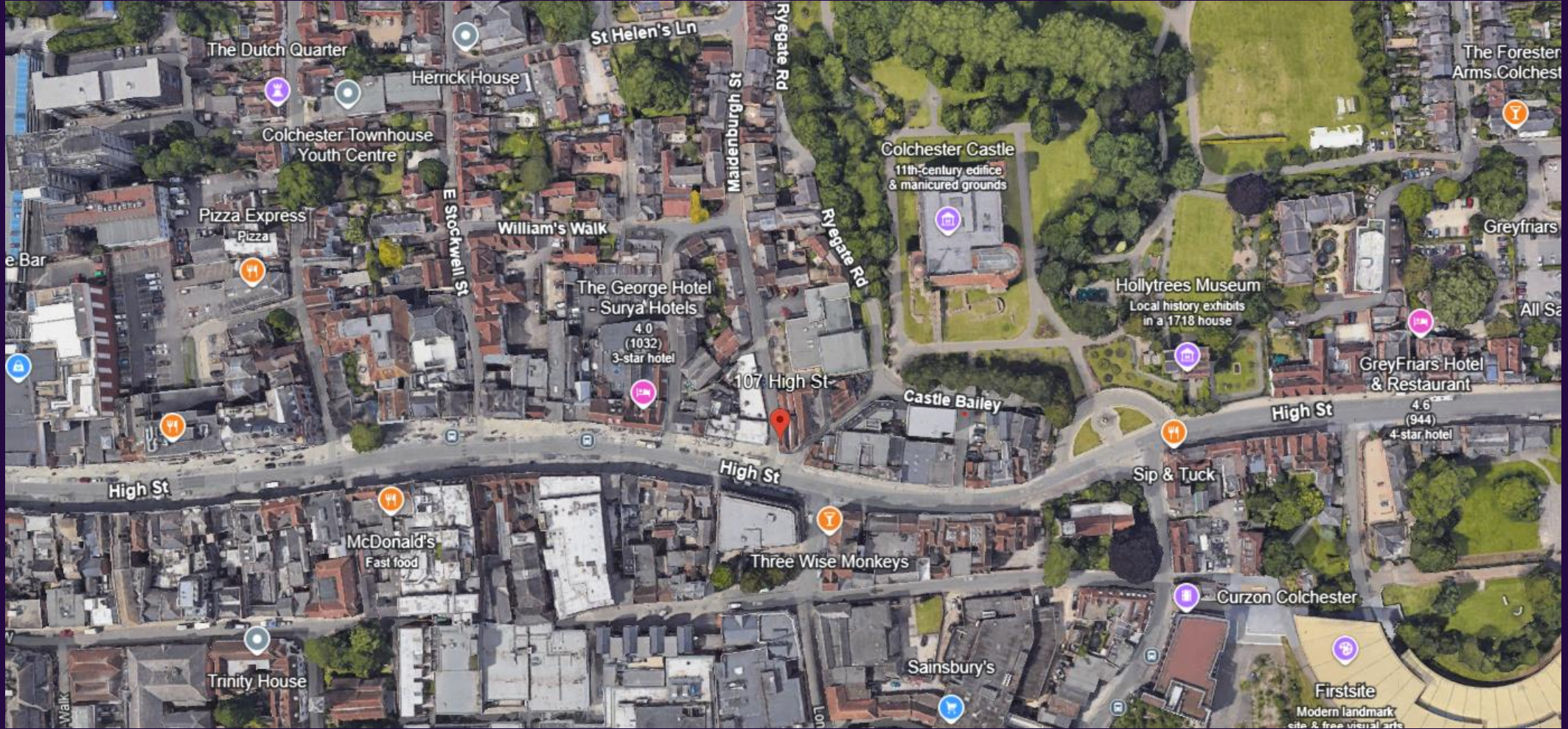

**Ewan Dodds BSc FRICS**  
ewan.dodds@whybrow.net  
01206 577667



**Maria Newman**  
m.newman@whybrow.net  
01206 577667



**Charntelle Goodyear**  
Charntelle.goodyear@whybrow.net  
01206 577667

01206 577667 | [info@whybrow.net](mailto:info@whybrow.net) | [whybrow.net](http://whybrow.net)

Misrepresentation Act 1967

Whybrow & Dodds Ltd. for themselves and for the vendors or lessors of this property whose agents they are give notice that (i) the particulars are set out as a general outline only for the guidance of intending purchasers or lessors and do not constitute part of an offer or contract, (ii) all descriptions, dimensions, references to condition and necessary permissions for use and occupation and other details are given in good faith and are believed to be correct, but their accuracy is not guaranteed and any intending purchaser or tenant should not rely on them as statements or representations of fact but must satisfy themselves by inspection or otherwise as to the correctness of each of them, (iii) no person in the employment of Whybrow & Dodds Ltd. Has any authority to make or give any representation or warranty in relation to this property. Whybrow & Dodds Ltd, 2 De Grey Square, De Grey Road, Colchester, Essex, CO4 5YQ. Registered in England No 2155295